

Slam Latch Series 708

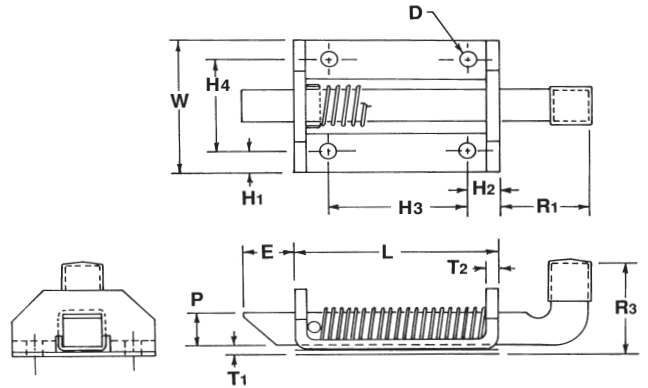
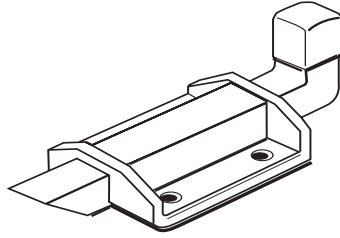

Available in 3 sizes:
7/16", 3/8" and 1/2" pins.
These rugged latches are ideal for doors, drawers, truck/trailer bodies, construction, farm equipment and all aircraft applications.

PIN (01)

P	Pin Size	.437
* E	Extension	.750
R1	Handle Length	1.000
R3	Handle Extension	1.250

BODY (02)

L	Length	2.000
* W	Width	1.625
T1	Thickness	.125
T2	Thickness	.120
* H1	Hole Location	.250
* H2	Hole Location	.375
H3	Hole Location	1.250
H4	Hole Location	1.125
* D	Hole Diameter	.203

MATERIAL

C = Stainless S = Steel

FINISH

Most commercial finishes are available, including zinc and cadmium on steel, passivate and electropolishing on stainless steel.

ORDERING INFORMATION

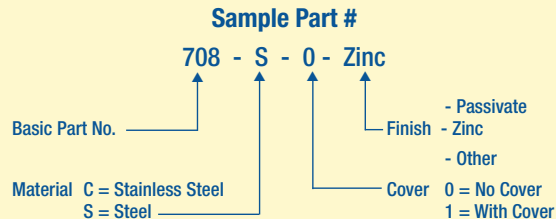

Special forms, offsets, hole sizes or welding projections are available to your specifications.

*Designated dimensions can be altered to meet your specifications.