

Spring Latch Series 718

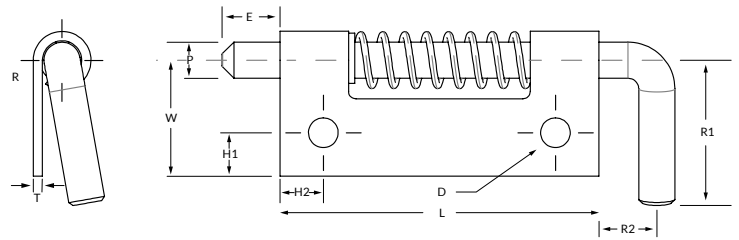

PIN

P	Pin Diameter	.375
* E	Extension	1.00
* R1	Handle Length	1.50
* R2	Handle Extension	1.50

BODY

L	Length	4.00
* W	Width	1.50
T	Thickness	.080
* H1	Hole Location	.620
* H2	Hole Location	.750

MATERIAL

	Steel	Stainless	Aluminum
Designation	S	C	A
Pin Type	12L14	303	SS
Body	1010	304	5052
Spring	302	302	302
C-Ring	PH15-7 MO	PH15-7 MO	PH15-7 MO

MODEL

R	Right Handed
L	Left Handed
U	Unassembled

POINT STYLE

Other styles available including long extensions	1		2		3		4		5	
		90° Cone		Ball		Bullet		Flat		60° Cone

FINISH

Most commercial finishes are available including zinc plate on steel, passivate and electropolishing on stainless steel, and anodize on aluminum.

ORDERING INFORMATION

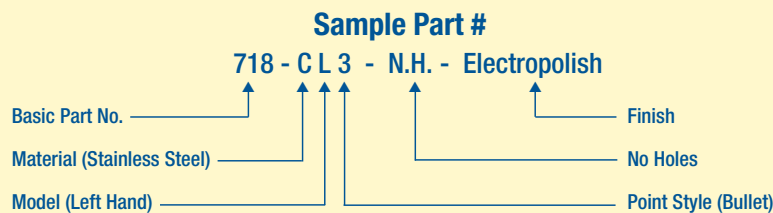

*Designates dimensions that can be altered to meet your specifications.